

Current Elementary School Attendance Boundaries for 2017-2018 School Year

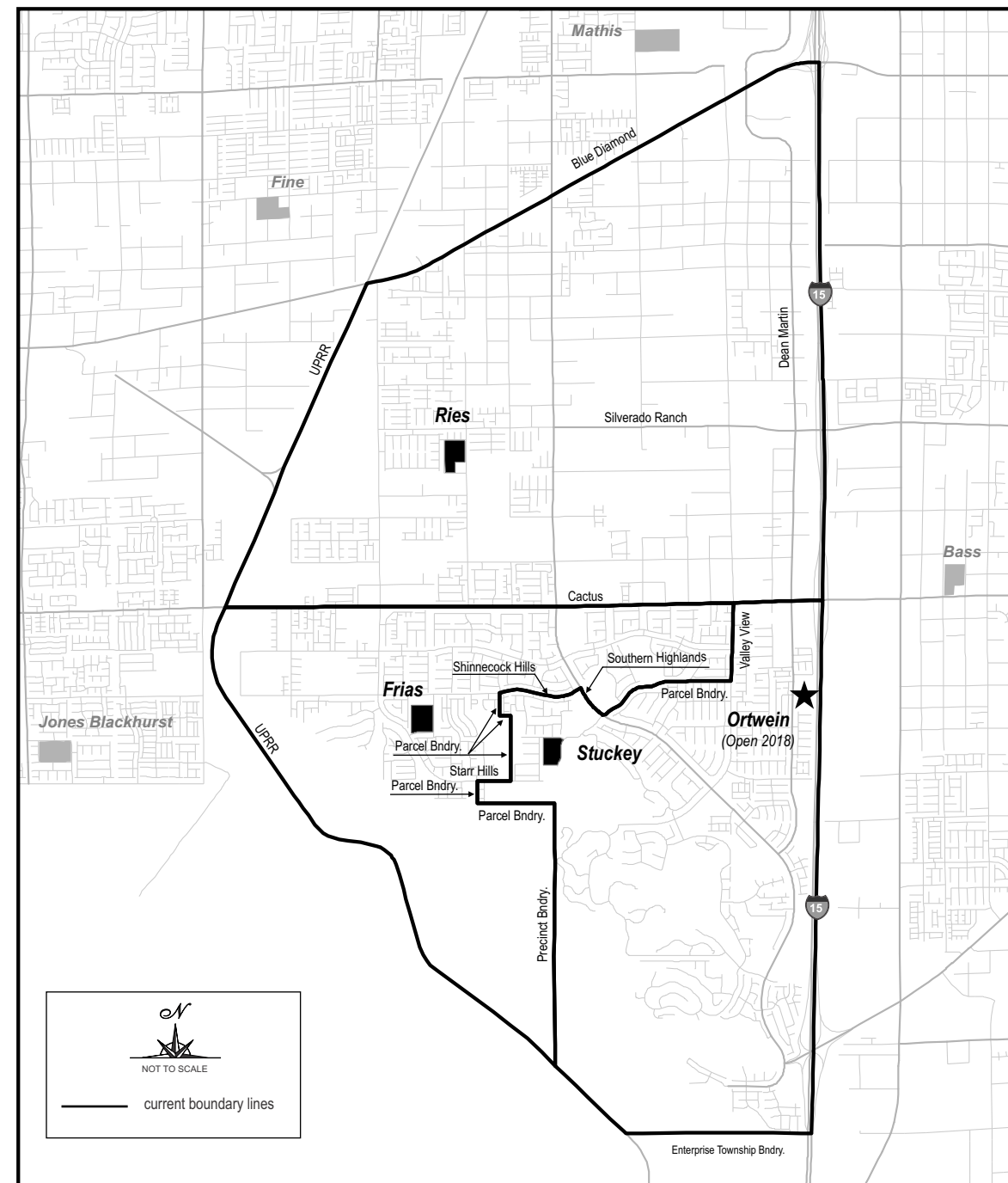

Elementary School Attendance Boundaries Public Input Meeting

The purpose of this focus area is to establish an attendance boundary for the new Dennis Ortwein Elementary School and to evaluate the existing attendance boundaries of Charles and Phyllis Frias, Aldeane Comito Ries, and Evelyn Stuckey Elementary Schools.

Thursday, January 18, 2018, 6:00 pm
Coronado High School Theater
 1001 Coronado Center Dr., Henderson, NV 89052

Your opportunity to be heard!

The Clark County School District's Board of School Trustees understands attendance boundary changes can be difficult for families and communities. To ensure their concerns are heard, the Board established the Attendance Zone Advisory Commission (AZAC). The members of AZAC are volunteers, parents, and concerned citizens appointed by the Board of School Trustees and the Superintendent of Schools to represent their individual districts. AZAC members review attendance boundaries each year and recommend changes to the Board of School Trustees.

Your input is a valuable part of this process. At public input meetings, proposals are presented which AZAC is considering for attendance boundaries in your area. They, along with school district staff, will be on hand to hear and consider your comments and suggestions. AZAC then formulates a final attendance boundary recommendation which will be forwarded to the Board of School Trustees for their approval on February 21, 2018 at 5:30 pm. This recommendation could be any variation of the proposals presented in this flyer, including no change to the current boundary.

If you wish to share your opinion, but are unable to attend the public input meeting, please mail your comments to AZAC, 1180 Military Tribute Place, Henderson, NV 89074, Email us at AZAC@interact.ccsd.net or visit our web-site: <http://azac.ccsd.net>. To speak with an individual AZAC member, please leave a message on the AZAC Hotline at 702-799-0239. Your AZAC member will return your call.

¡Su oportunidad de ser escuchado!

La Mesa Directiva del Distrito Escolar del Condado de Clark comprende que los cambios de los límites de zona escolar pueden causar inconvenientes para las familias y las comunidades. Para asegurar que las preocupaciones de la comunidad se escuchen, la Mesa Directiva estableció una Comisión de Asesoramiento de Zona de Asistencia Escolar (AZAC). Los miembros de AZAC son voluntarios, padres de familia y ciudadanos interesados en el bienestar del alumno. Los miembros de AZAC son elegidos por la Mesa Directiva y el Superintendente del distrito escolar para representar sus respectivos distritos. Los miembros de AZAC repasan los límites de zona escolar cada año y recomiendan los cambios a la Mesa Directiva.

Su opinión es una parte valiosa en este proceso. En las reuniones públicas, los miembros de AZAC presentan las propuestas de los límites de zona que son consideradas en su área. Los miembros de AZAC y el personal del distrito escolar estarán allí listos para oír y considerar sus comentarios y sugerencias. Después los miembros de AZAC definen y finalizan las recomendaciones y las remiten a la Mesa Directiva para su aprobación el 21 de febrero, 2018 a las 5:30 pm. Esta recomendación puede variar en las propuestas presentadas en este folleto, sin incluir ningún cambio en los límites de zona actual. Si usted desea compartir su opinión pero no puede asistir a la reunión pública, por favor envíe sus comentarios a AZAC, 1180 Military Tribute Place, Henderson, NV 89074 o visite la página de internet: <http://azac.ccsd.net>. Para comunicarse con un miembro de AZAC, por favor deje un mensaje en la línea AZAC al 702-799-0239, y su llamada se le regresará.

AZAC members represent the following Trustee Districts:
 Los miembros de AZAC representan los siguientes respectivos distritos de la Mesa Directiva:

District	Trustee	AZAC Members	District	Trustee	AZAC Members
A	Deanna L. Wright	Mallory Levins and Dave Flatt	E	Lola Brooks	Matthew Tramp and Rachel Wren
B	Chris Garvey	Glen Olsen and Dr. Shari Lyman	F	Carolyn Edwards	Nicole Benson and Albert Delgado
C	Dr. Linda E. Young	Lois Mack and Mike Malone	G	Linda P. Cavazos	Angela Haldeman and Cyndy Mahoney
D	Kevin L. Child	Becky Nielson and David Gomez			

Pat Skorkowsky, Superintendent of Schools
 Diane Kinsel, Superintendent Appointed Representative to AZAC

Proposal 1
Elementary School Attendance Boundaries
for 2018-2019 School Year

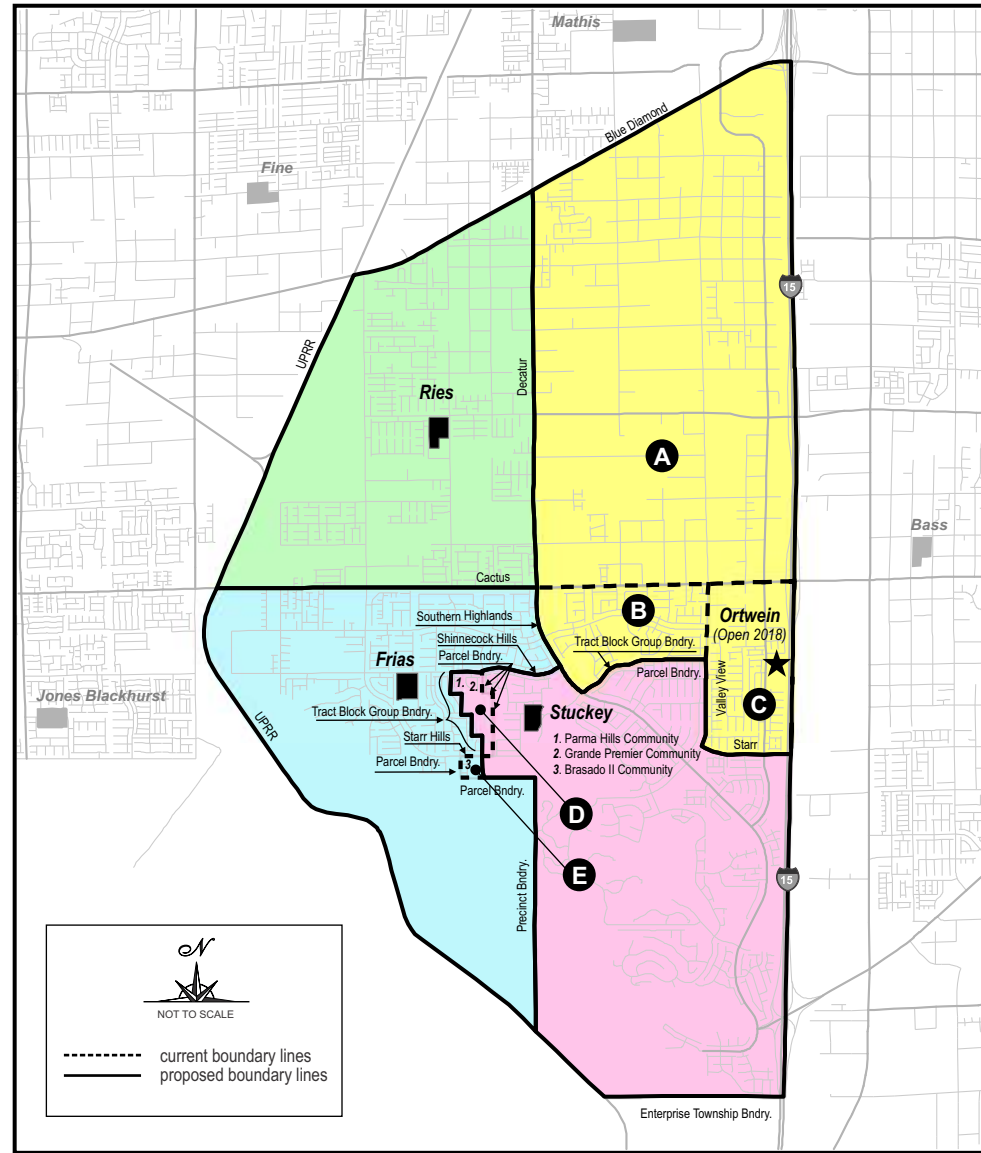

Proposed Areas for Zoning Consideration

- A** From Aldeane Comito Ries Elementary School to Dennis Ortwein Elementary School
- B** From Charles and Phyllis Frias Elementary School to Dennis Ortwein Elementary School
- C** From Evelyn Stuckey Elementary School to Dennis Ortwein Elementary School
- D** From Charles and Phyllis Frias Elementary School to Evelyn Stuckey Elementary School
- E** From Evelyn Stuckey Elementary School to Charles and Phyllis Frias Elementary School

Proposal 2
Elementary School Attendance Boundaries
for 2018-2019 School Year

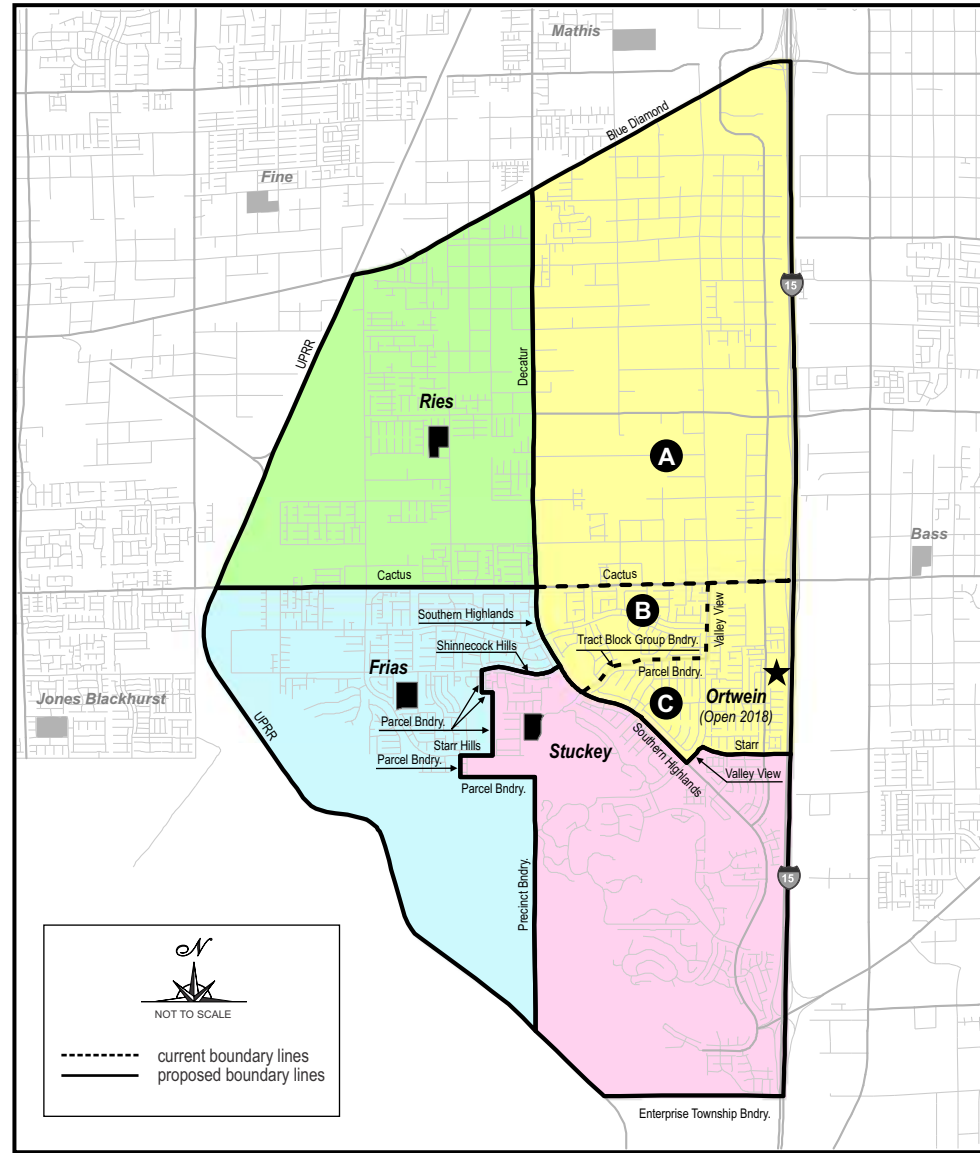

Proposed Areas for Zoning Consideration

- A** From Aldeane Comito Ries Elementary School to Dennis Ortwein Elementary School
- B** From Charles and Phyllis Frias Elementary School to Dennis Ortwein Elementary School
- C** From Evelyn Stuckey Elementary School to Dennis Ortwein Elementary School

Proposal 3
Elementary School Attendance Boundaries
for 2018-2019 School Year

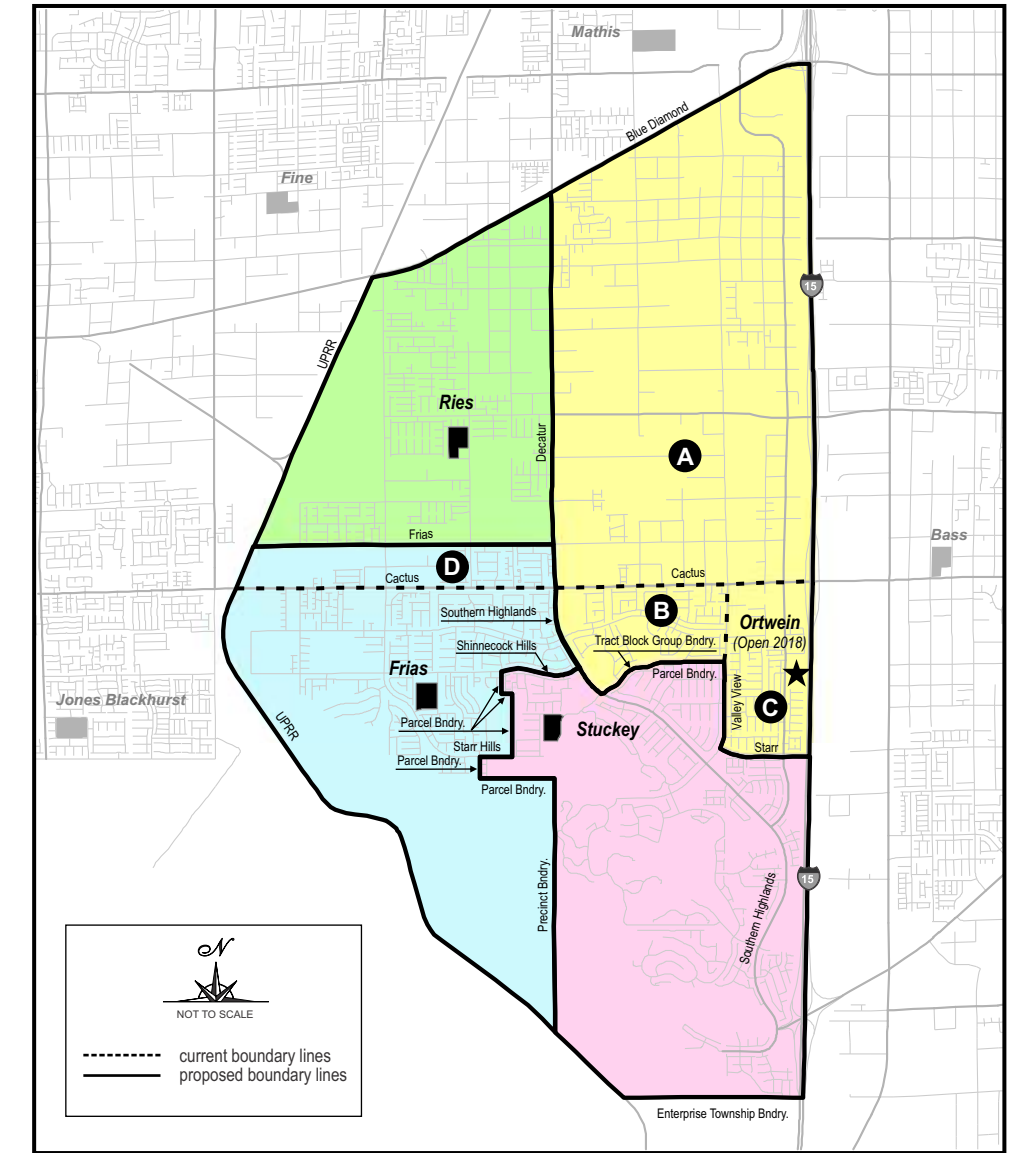

Proposed Areas for Zoning Consideration

- A** From Aldeane Comito Ries Elementary School to Dennis Ortwein Elementary School
- B** From Charles and Phyllis Frias Elementary School to Dennis Ortwein Elementary School
- C** From Evelyn Stuckey Elementary School to Dennis Ortwein Elementary School
- D** From Aldeane Comito Ries Elementary School to Charles and Phyllis Frias Elementary School