

CLARK COUNTY SCHOOL DISTRICT BOARD OF TRUSTEES APPROVED CHANGES TO NORTHEAST ELEMENTARY SCHOOL ATTENDANCE BOUNDARIES FOR 2018-2019 SCHOOL YEAR

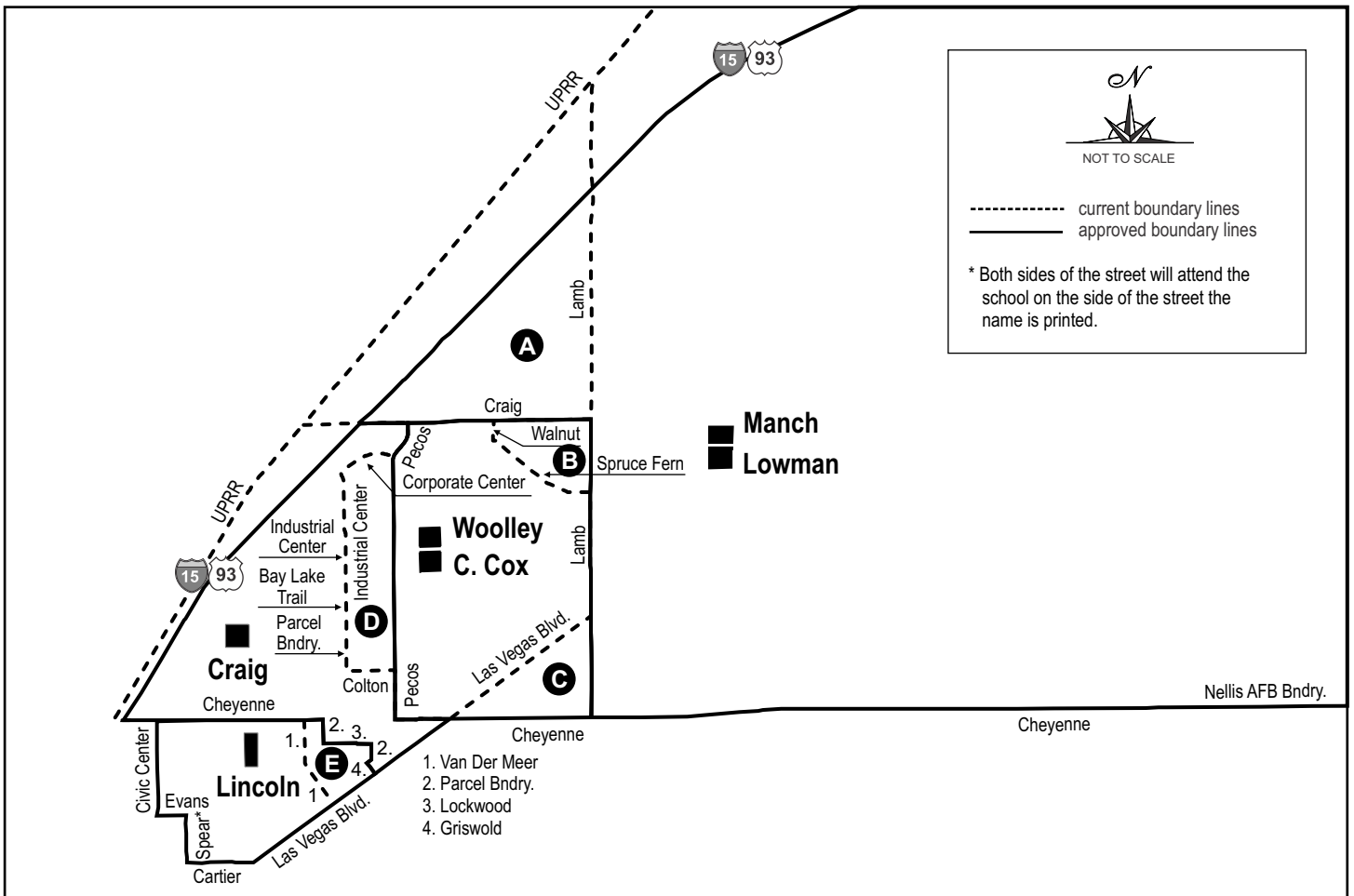

Approved Zoning Changes

- A** From Gwendolyn Woolley and Clyde C. Cox Elementary Schools to J. E. Manch and Mary and Zel Lowman Elementary Schools.
- B** From J. E. Manch and Mary and Zel Lowman Elementary Schools to Gwendolyn Woolley and Clyde C. Cox Elementary Schools.
- C** From J. E. Manch and Mary and Zel Lowman Elementary Schools to Gwendolyn Woolley and Clyde C. Cox Elementary Schools.
- D** From Gwendolyn Woolley and Clyde C. Cox Elementary Schools to Lois Craig Elementary School.
- E** From Lois Craig Elementary School to Lincoln Elementary School.