

**CLARK COUNTY SCHOOL DISTRICT BOARD OF TRUSTEES
APPROVED CHANGES TO SOUTHEAST
MIDDLE AND JUNIOR HIGH SCHOOL ATTENDANCE BOUNDARIES
FOR 2018-2019 SCHOOL YEAR**

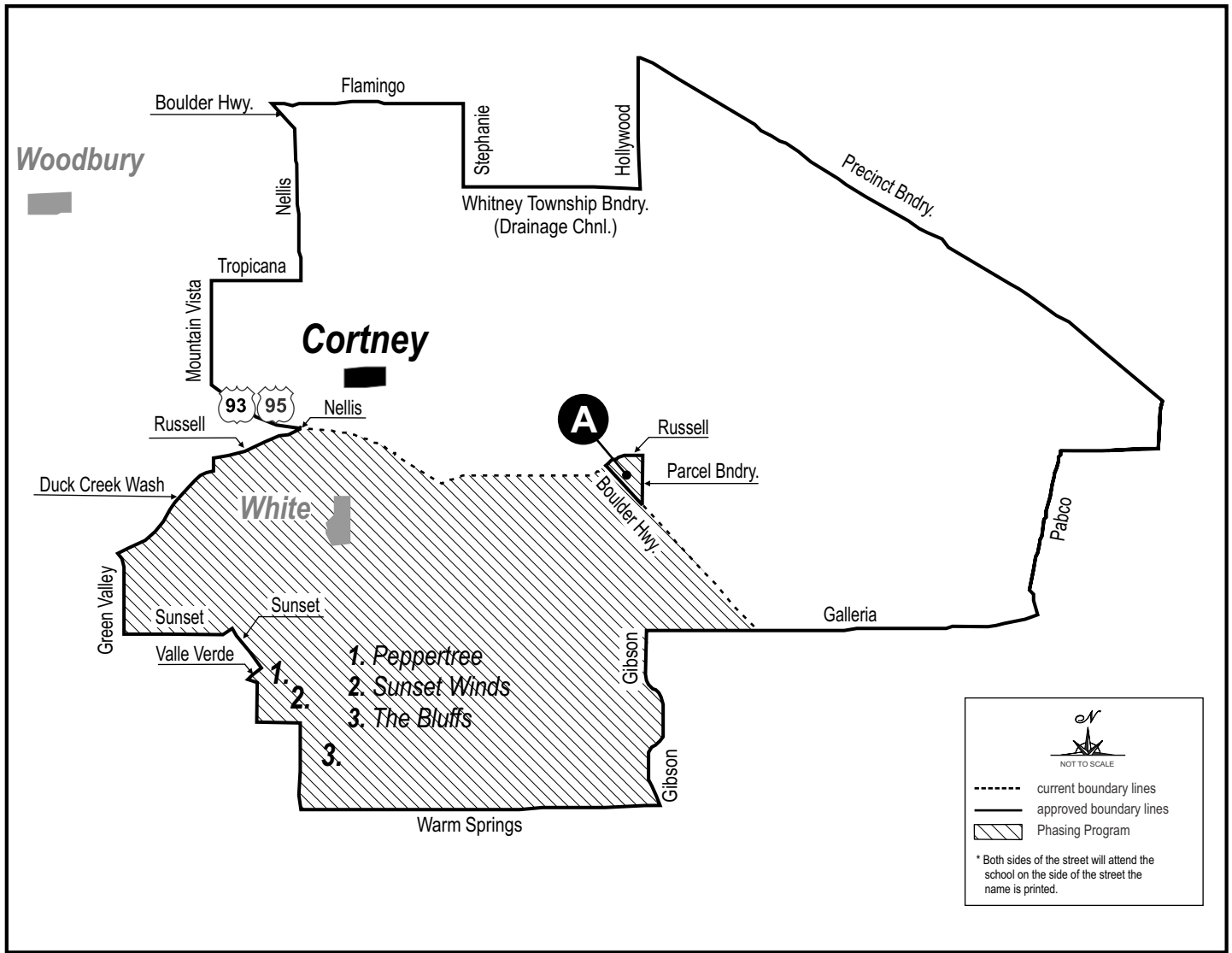

Approved Zoning Changes

- A** From Thurman White Academy of the Performing Arts Middle School to Francis H. Cortney Junior High School

Please note, as of the 2018-2019 school year, Thurman White Middle School will expand to a full dedicated magnet program, Academy of the Performing Arts and as a result of the new magnet program implementation it is necessary to reassign incoming 6th grade students starting the 2018-2019 school year. Beginning with the incoming 6th grade students for the 2018-2019 school year, students must apply for, and be accepted into the Thurman White Academy of the Performing Arts Middle School. All 6th and 7th grade students assigned to and enrolled Thurman White Middle School for the 2017-2018 school year, will be allowed to continue at Thurman White Middle School Academy of the Performing Arts for the duration of their middle school career.

The Thurman White Middle School attendance boundary will be dissolved in phases, dissolving one grade level per year, beginning with the 6th grade in the 2018-2019 school year, and will continue until all grades, 6-8, have been reassigned.

Phasing Program

This attendance boundary change will occur in phases, by reassigning one grade level each year until all grades, 6-8, have been reassigned. Beginning with the 6th grade phasing will be implemented at the start of the 2018-2019 school year.

An option for older siblings to attend at their younger siblings' designated school is provided, with transportation, if eligible as indicated in Policy and Regulation 3531. Future annual assessments of the area demographics will be conducted and may result in canceling program by implementing the entire attendance boundary adjustment, as approved, at once.