

Clark County School District Board of Trustees
Approved STAFF Changes to East Middle / Junior High School
Attendance Boundaries for 2019-2020 School Year

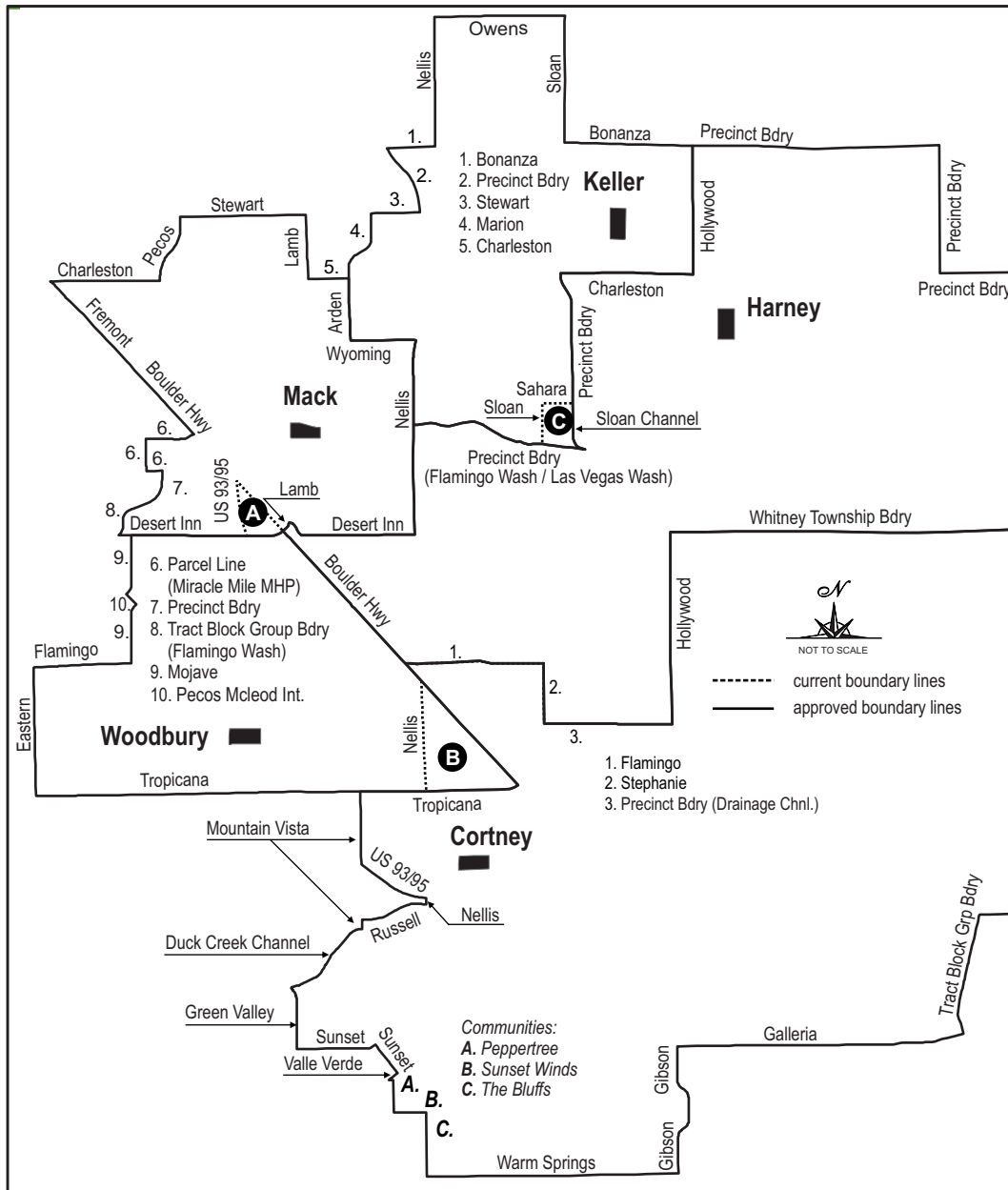

Approved Zoning Changes

- A** From C. W. Woodbury Middle School to Jerome D. Mack Middle School
- B** From Francis H. Cortney Junior High School to C. W. Woodbury Middle School
- C** From Kathleen and Tim Harney Middle School to Duane D. Keller Middle School

Approved NO CHANGE
 from Francis H. Cortney Junior High School
 to Kathleen and Tim Harney Middle School

Approved Phasing Program

The approved attendance boundary change will occur in phases, by reassigning one grade level each year until all grades, 6-8, have been reassigned. Beginning with the 6th grade phasing will be implemented at the start of the 2019-2020 school year.

An option for older siblings to attend their younger siblings' designated school is provided, with transportation, if eligible as indicated in Policy and Regulation 3531.

Future annual assessments of the area demographics will be conducted and may result in canceling phasing program by implementing the entire attendance boundary adjustment, as approved, at once.